

LOCAL AREA TRAFFIC MANAGEMENT SCHEME

It's all part of Council's plan

Gray Street, New Farm

Advice about an important traffic proposal for your local area

Dear Resident / Property Owner

Brisbane City Council is aware that some residents have raised concerns about traffic speeds and vehicle volumes in Gray Street. To address this issue Council is undertaking consultation and seeking your feedback and comments regarding the installation of traffic calming measures.

The proposed options for the traffic calming build out and/or platform device have been provided on the locality plan inside this newsletter.

Please be aware of the following regarding the installation of traffic calming measures:

- Understand the possible impacts traffic management devices may have in terms of inconvenience
- Understand the installation of devices may also lead to increased traffic noise because of vehicles negotiating devices
- You support the installation of traffic device being outside your premises

COUNCIL IS SEEKING YOUR VIEWS ON THIS PROPOSAL

Please complete the response section inside this newsletter, detach and fold as indicated on the back, seal it and post it back to Council (at no cost) by **7 November 2014**. The proposed option will only be implemented if supported by at least 60% of consulted properties. **If no response is received, it will be considered that you are NOT in favour of any of the proposed options.**

Should you wish to discuss details of this proposal please contact Mr David Clarke on (07) 3403 8888 or e-mail TPS_Contact@brisbane.qld.gov.au

If you are not the property owner, it would be appreciated if you would pass this section of the newsletter on to your landlord or rental agency



Dedicated to a better Brisbane

Indicative Scheme Plan (not to scale):

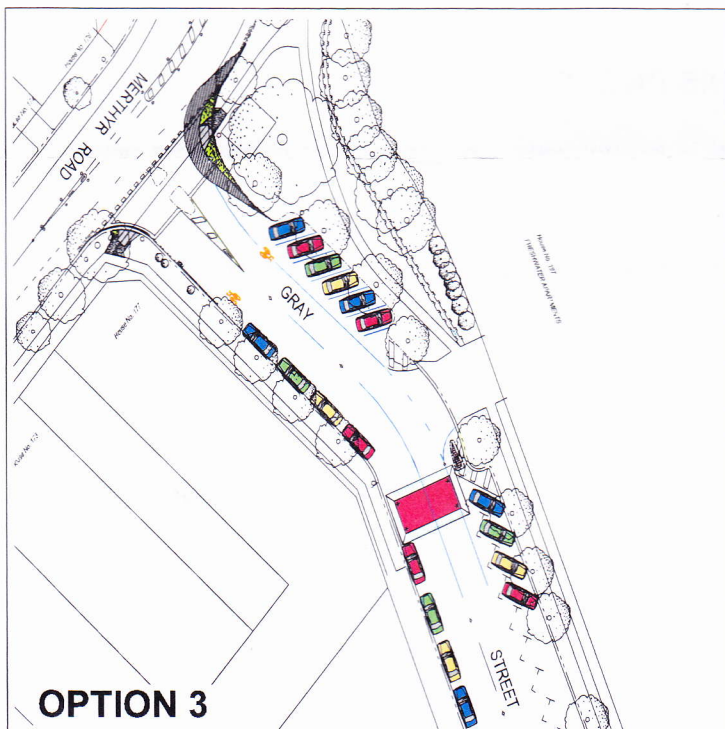
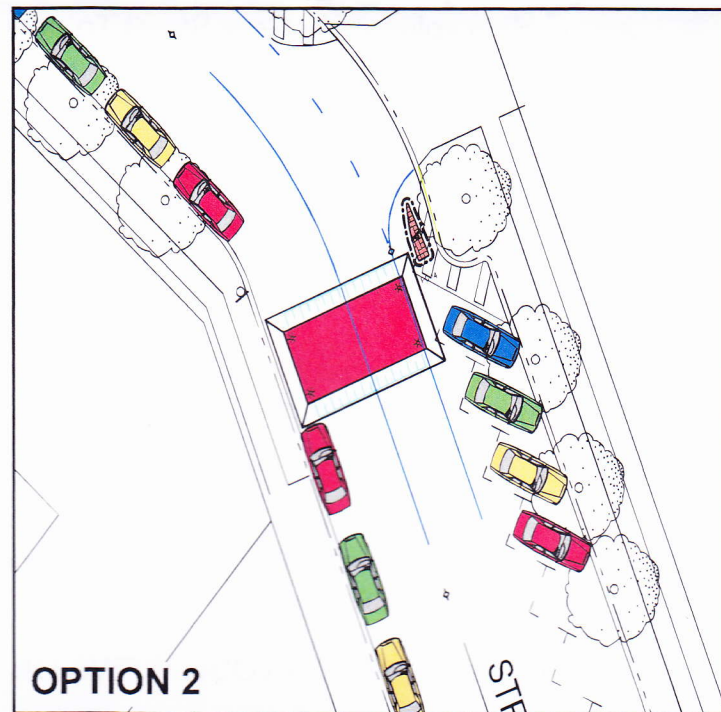
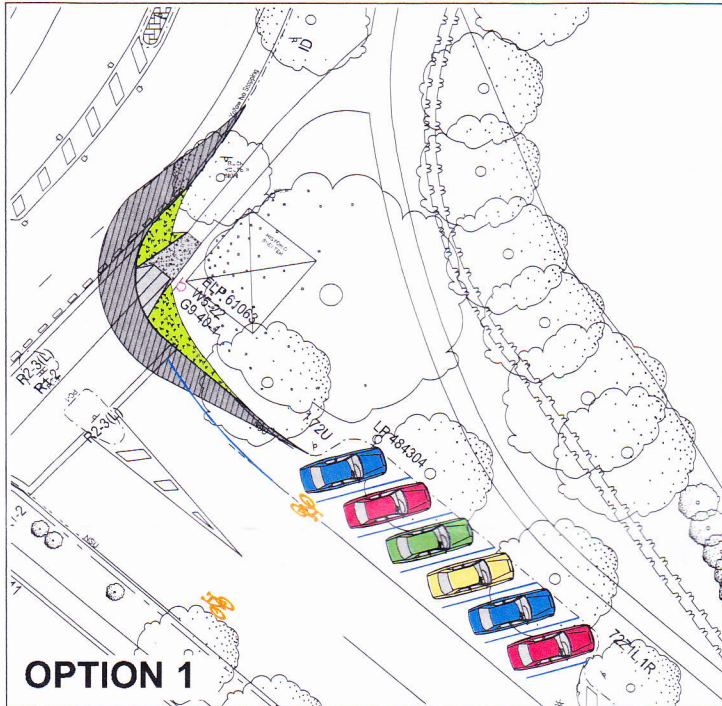

RESPONSE FORM

Collection Notice: The personal information provided below will be used by Brisbane City Council (BCC) or agents of BCC for the purpose of assessing if a Local Area Traffic Management scheme has sufficient support to detailed design. Council may use this information to contact you about the scheme

Name: Phone:

Email: Property Number:

Street: Signature:

Are you the property owner? [Please mark appropriate box]: ☐ YES ☐ NO

In relation to the proposed Traffic Management Scheme for our area, our household support [Please mark appropriate box]:

☐ OPTION 1 - Kerb Build Out

☐ OPTION 2 - Speed Platform

☐ OPTION 3 - Kerb Build Out & Speed Platform

Comments:

This image shows a single sheet of white paper with horizontal dotted lines, similar to standard notebook paper. The lines are evenly spaced and run across the width of the page. There is no handwriting or other markings on the paper.

THANK YOU For Participating

We appreciate your involvement

.....First fold

Delivery Address:
GPO Box 1434
BRISBANE QLD 4001

No stamp required
if posted in Australia



Brisbane City Council
Transport Network Operations - BSQ Lvl 6
Reply Paid 1434
BRISBANE QLD 4001

.....Second fold

Please dispose of this flyer thoughtfully.

**Brisbane City Council
Information**
GPO Box 1434
Brisbane Qld 4001

Printed on recycled paper



M2010-00XX

© Brisbane City Council 2010

For more information visit
www.brisbane.qld.gov.au
or call (07) 3403 8888.